

**PZB**  
PZ24-12000027  
06/24/2026

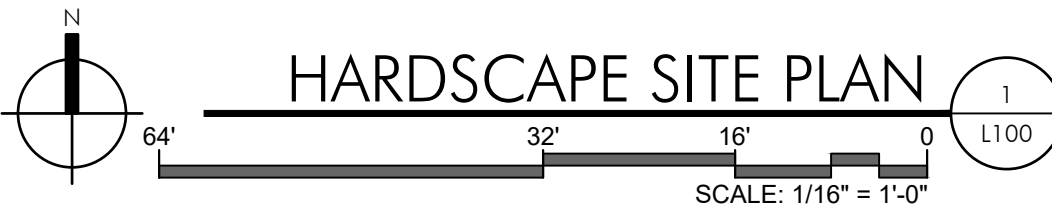

**absolute-idea.com**  
CANAL PARK  
3323 NE 163rd Street, Suite 200 North Miami Beach, FL 33160  
305.792.0015 305.931.0279 info@absolute-idea.com

SEAL  
KEN GARDNER  
FLA 1569  
TO THE BEST OF MY KNOWLEDGE, THE PLANS AND SPECIFICATIONS COMPLY WITH THE MINIMUM REQUIREMENTS FOR THE PROJECT AND THE APPLICABLE PROFESSIONAL STANDARDS AND REGULATIONS OF THE STATE OF FLORIDA.

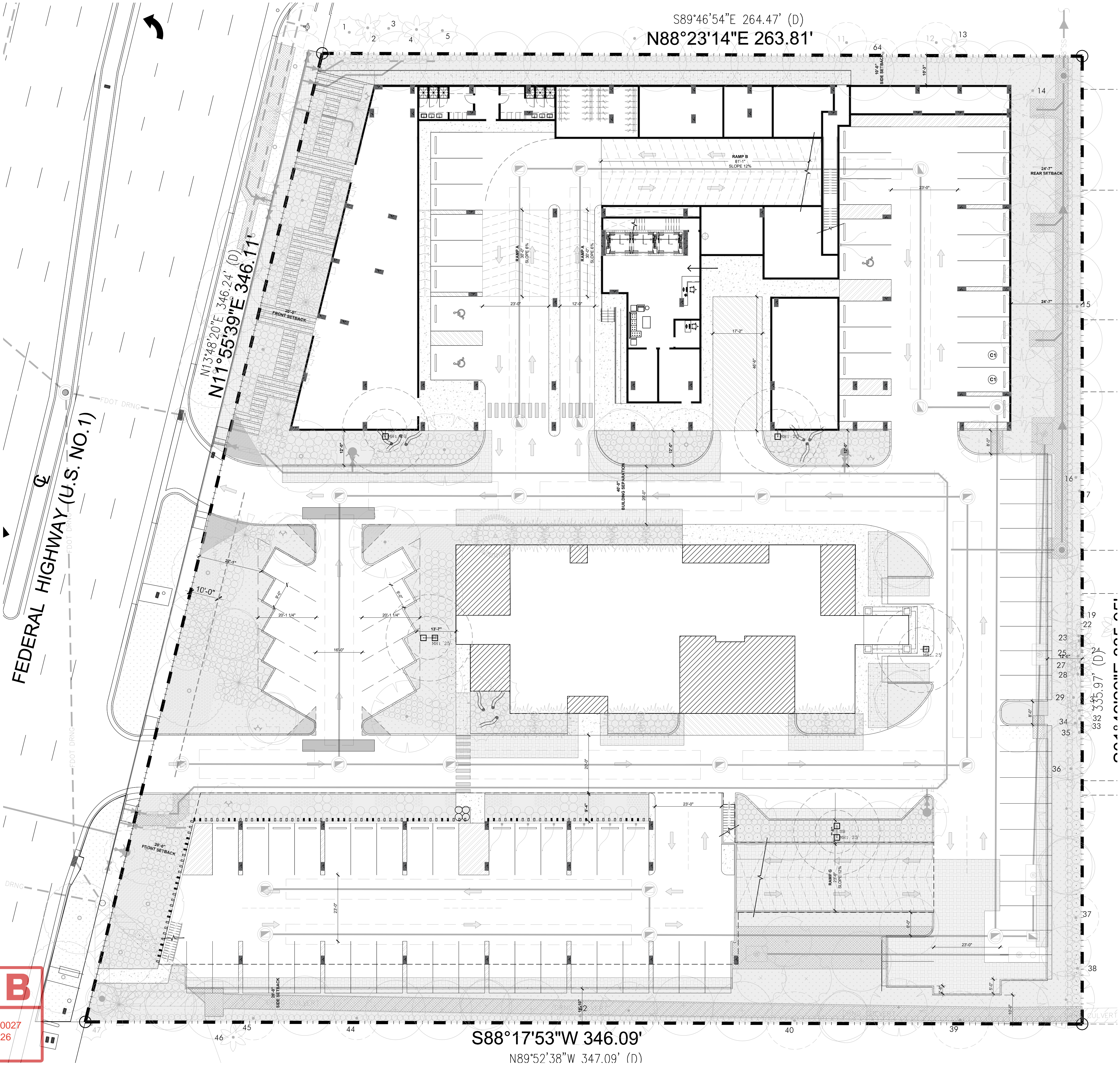
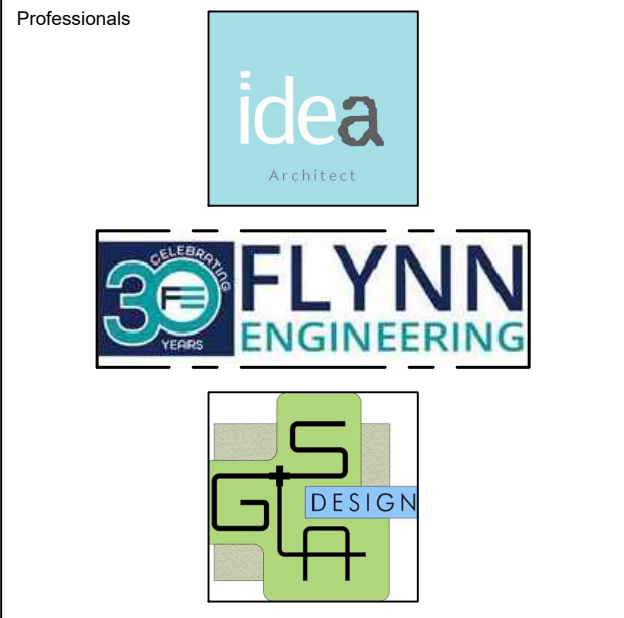

REV.	DATE	DESCRIPTION
01	XX-XX-2024	D.R.C SUBMITAL

ALL MEASUREMENTS MUST BE VERIFIED BEFORE BEGINNING THE WORKS. NO MEASUREMENTS ARE TO BE SCALED DIRECTLY FROM THIS DRAWING.

Key section

Client  
**VERA FUND**  
NICK POLYUSHKIN  
& YURI KHARITONENKOV  
TEL: 305.833.3303

Project  
**1600 S FEDERAL HIGHWAY  
(MIXED-USE PROJECT)**  
1600 SOUTH FEDERAL HIGHWAY,  
POMPAHO BEACH, FL 33062

Title	
HARDSCAPE SITE PLAN	
Drawn GSLA	Field LANDSCAPE ARCH
Verified KG	Scale as shown
Approved KG	Date 10-09-2024
Project Manager KG	Dwg. no.
Project 24-838	L-100